

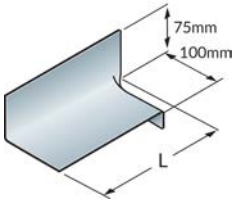

Soakers and step flashings

A. Soakers



Size of soaker
 $L = \text{gauge} + \text{lap} + 25\text{mm}$

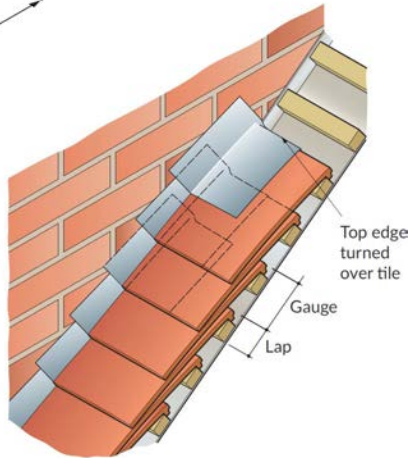

B. Marking - out step flashing

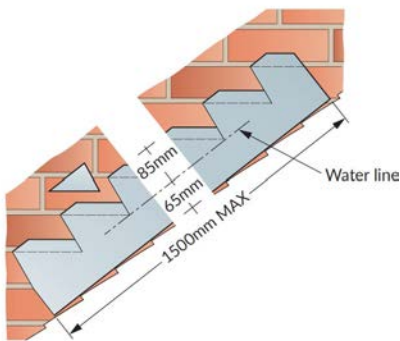

Note: No flashing piece to exceed 1.5m in length.

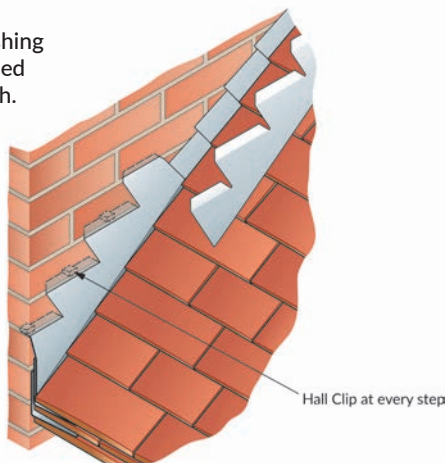

Cover flashings

A. Cover flashing to a felt roof upstand

Note: No flashing piece to exceed 1.5m in length.

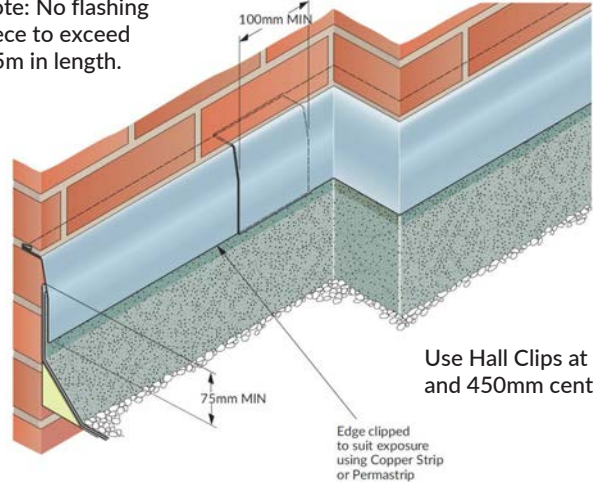

B. Cover flashing to asphalt upstand

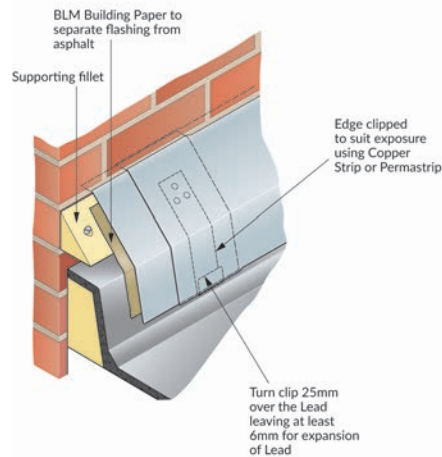

C. Cover flashings, roof pitches up to 3°

Use Hall Clips at laps and 450mm centres.

