

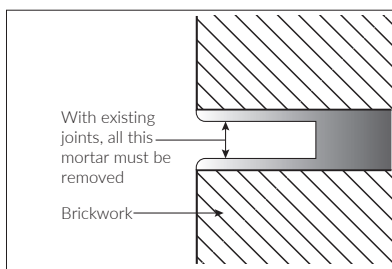

# FIXING FLASHINGS

## Rolled Lead Sheet to BS EN 12588

### Cleaning Joints



When removing mortar from an existing joint it is important to remove ALL the mortar to a depth of at least 25mm.

### Joints Between 6mm-26mm Wide

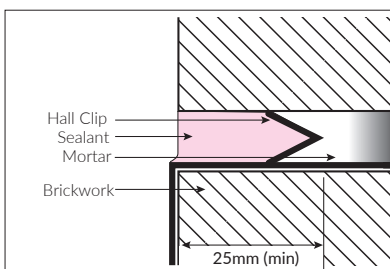

The joint should be at least 6mm wide to allow Hall Clips to be inserted to hold the Lead flashing in place before pointing in with BLM Lead Pointing Sealant.

### Joints Over 18mm Wide

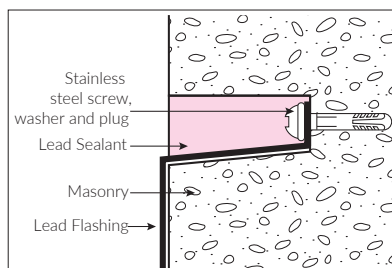

Wide joints over 18mm will require a more substantial fixing. Hall Clip Plus can be used for chase heights of 18-26mm. It is recommended that stainless steel screws and washers are used at 450mm centres on flashing lengths of no longer than 1500mm. The joint should be pre-pointed with mortar and then pointed with BLM Lead Pointing Sealant.

Joints over 20mm wide should comprise half mortar and half BLM Lead Pointing Sealant, the nozzle should be cut at an angle and the sealant applied to both the top and bottom of the joint once the mortar at the rear of the joint has set.

### Joints With A DPC

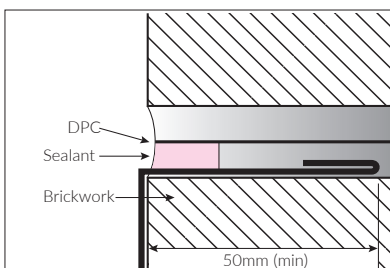

Joints below a DPC can often cause problems if they are not fitted correctly. On new buildings the Flashing can be inserted during construction, using a single welt to hold it in position. A batten, the same height as the joint and 25mm wide may be used to support the DPC until the mortar has set. The batten is then removed leaving a clean void for pointing with BLM Lead Pointing Sealant. On existing buildings it is often better to chase out a joint at least 600mm below the DPC, this will avoid any potential damage to the damp proof membrane by disturbing the brickwork or masonry above it.

### Helpful Hints

- Always ensure joints are thoroughly cleaned and no mortar remains
- Individual flashing lengths should not exceed 1500mm
- Joints under 26mm wide should be held firmly in place with Hall Clips Standard or Hall Clips Plus
- Using Hall Clips instead of Lead wedges will help to prevent the easy theft of Lead flashings
- Use at Least 1 Hall Clip per step when fitting step flashings
- Use 1 Hall Clip at 450mm centres and where flashing pieces overlap when fitting linear flashings
- Joints over 18mm wide can also be secured with stainless steel screws and washers
- Use BLM Lead Pointing Sealant to point in the Lead in to the masonry
- Ensure joint is completely dry before applying the sealant
- Cut the Sealant nozzle to suit the width of the joint
- Minimum depth of the sealant should be no less than 10mm
- The face of the sealant can be smoothed using a wet pointing tool

