

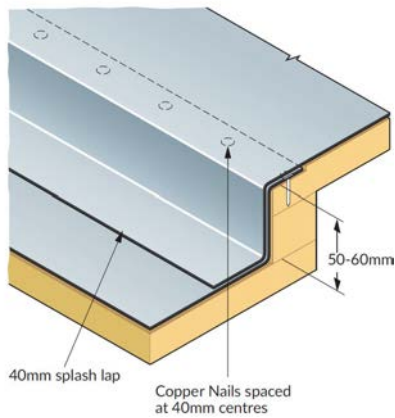

Drips and rolls

A. Drip (up to 3°)



B. Drip (over 3°)

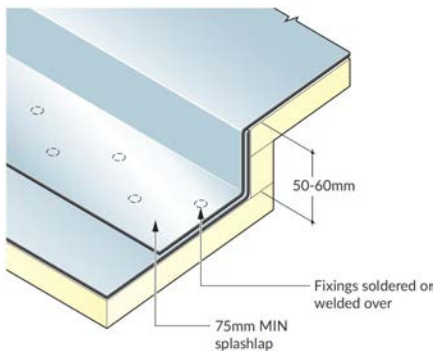

C. Box gutter drip without splash laps

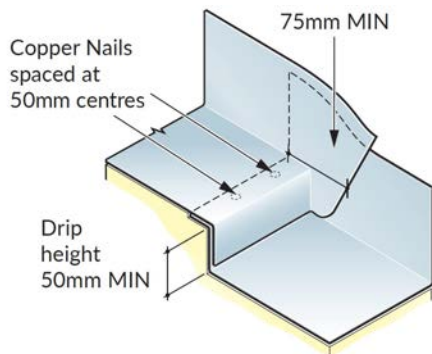

D. Tapered gutter drip without splash laps

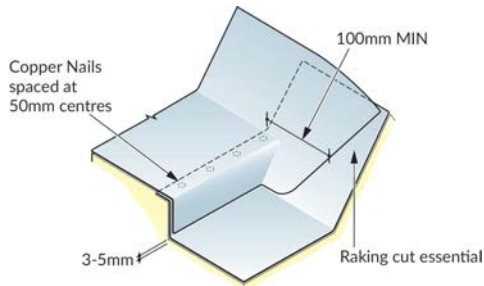

E. Standard wood cored roll with splash lap

Cross section of wood cored roll joint

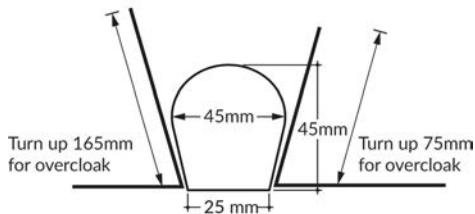

F. Standard wood cored roll with splash lap

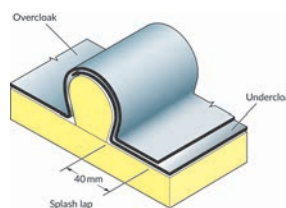

Wood cored roll joints are suitable for all roofing and cladding applications.

Nail the roll undercloak at the top third of the length only using Copper Nails at 50mm centres.

G. Roll drip intersections for wide gutters

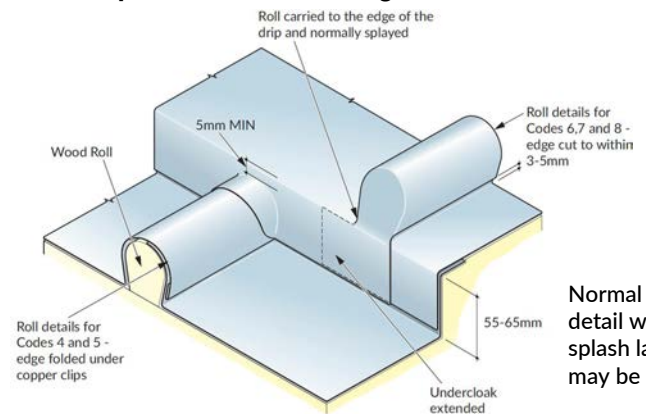

Normal roll detail with splash lap may be used.

Table 1

Gutter drip heights	
BS EN 12588 Code No	Minimum drip height (mm)
4,5 and 6	50 where there is no roll to drip intersection
4	55
5	55
6	55
7	60
8	60

